

**CBD15J-Li**  
Lithium Battery Powered Pallet Truck

合力 小锂电

Helix Mini power pallet with Lithium battery

**Characteristics:**

1. Simple, flexible, light weight and small turning radius make the truck suitable use in extremely narrow aisle.
2. Strong structure and open layout make the maintenance easy
3. Same hydraulic pump with the hand pallet, simple and reliable
4. Integrated handle integrates key and meter make the operation easy and comfortable.
5. Portable lithium-battery pack provides easy and speedy battery change.
6. Emergency reversing device ensure safety operation.
7. Auxiliary wheels on two sides provide well stability.
8. Manual lift is available as option.



**CBD15J-Li**  
Lithium Battery Powered Pallet Truck

制造商和技术参数 Manufacturer's Data and Design Characteristics

Characteristics			
1.1	Manufacturer	HELI	
1.2	Model	CBD15J-Li	
1.3	operator type	Pedestrian propelled	
1.4	rated capacity	Q (kg)	1500
1.5	lift height	h3 (mm)	200
1.6	Service weight with battery	kg	152
1.7	Load centre	c (mm)	600
1.8	Axle centre to fork face	x (mm)	944
1.9	Wheel base	y (mm)	1243
Wheels			
2.1	Tyre type	Polyurethane	
2.2	Tyre size, driving wheels	φ × v (mm)	φ210 × 70
2.3	Tyre size, loading wheels	φ × v (mm)	φ80 × 60
2.4	Wheels, number front/rear (x = driven)	1x+2/4	
2.5	Track width, rear, loading side	b11 (mm)	400/535
Dimensions			
3.1	Overall length	l1 (mm)	1615
3.2	Length to fork face	l2 (mm)	465
3.3	Overall width	b1 (mm)	550/685
3.4	Fork dimensions	s/e1 (mm)	50/150/1150
3.5	Width of forks	b5 (mm)	550/685
3.6	lowered height	h13 (mm)	85
3.7	Min.Ground clearance	m2 (mm)	35
3.8	height drawbar in driving position min. / max.	h14 (mm)	610/1212
3.9	Aisle width with pallet1000 × 1200 across forks	Ast (mm)	1815
3.10	Aisle width with pallet600 × 1200 along forks	Ast (mm)	1865
3.11	Min.Turning radius	Wa (mm)	1405
Performance			
4.1	Travel speed,with/without load	(km/h)	4.2/4.5
4.2	Max. gradesability laden/unladen	(%)	5/8
4.3	Service brake type	Electromagnetic brake	
5.1	Drive motor,output S2 60 min.	(kW)	0.75
5.2	Lift motor rating at S3 15%	(kW)	0.8
5.3	Battery according to DIN 43531/35/36 A,B,C,no	No	No
5.4	Battery voltage/rated capacity	(V/Ah)	24/35
5.5	Battery weight (± 5%)	(kg)	7
Others			
6.1	Type of drive control	DC	
6.2	sound pressure level at the driver' s ear	(dB(A))	≤75
6.3	Steering type	Mechanical steering	

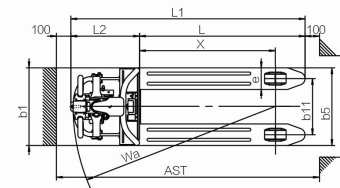
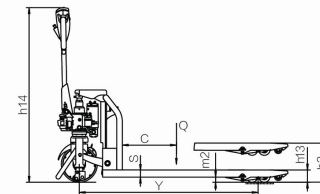

**ANHUI HELI CO., LTD.**

ADD: NO.668 Fangxing Street,Economical Development Zone,Hefei,P.R.China  
TEL:(86 551)63639068(America); 63639258(Europe);  
63639358(Asia); 63662105(Africa & Middle East);  
63639530(Warehouse Equipment); 63639531(Wheel loader)  
FAX:(86 551)63639966  
WEBSITE: <http://www.helichina.net>

AUTHORIZED DEALER